

**Tools: allen key no. 8, 5  
wrench no. 17, 13**

**BIG COUPLING**

1 pc 10x40 screw  
2 pcs washers  
1 pc nut

**SMALL**

4 pcs 8x16 screws  
4 pcs washers  
4 pcs nuts



1. Position lower metal sheet (with arrow) under the footrest
2. Position the upper metalsheet over the footrest and start insert the screws, washers and nuts and tighten
3. Couple the trailer hitch onto the holes with the big screw (10x 40) and tighten

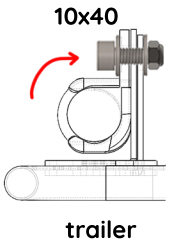
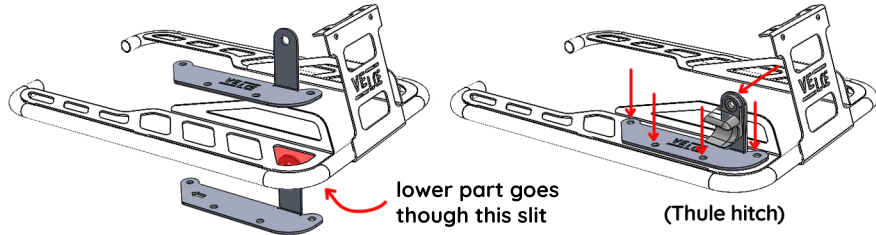

In case of doubt contact your Veloe® retailer for a safe and comfortable ride

© veloe

more accessories at veloe.eu

**Tools: allen key no. 8, 5  
wrench no. 17, 13**

**BIG COUPLING**

1 pc 10x40 screw  
2 pcs washers  
1 pc nut

**SMALL**

4 pcs 8x16 screws  
4 pcs washers  
4 pcs nuts



1. Position lower metal sheet (with arrow) under the footrest
2. Position the upper metalsheet over the footrest and start insert the screws, washers and nuts and tighten
3. Couple the trailer hitch onto the holes with the big screw (10x 40) and tighten

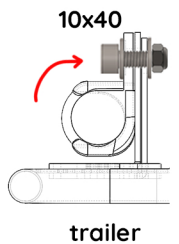
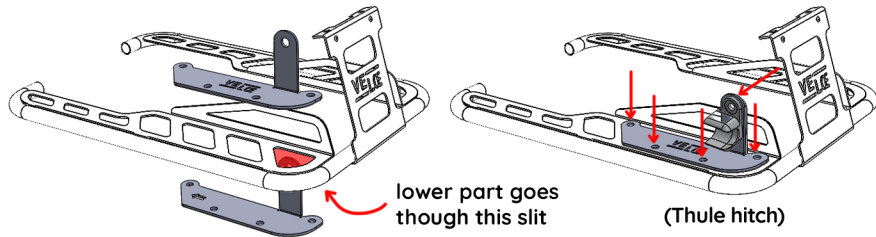

In case of doubt contact your Veloe® retailer for a safe and comfortable ride

© veloe

more accessories at veloe.eu

**Tools: allen key no. 8, 5  
wrench no. 17, 13**

**BIG COUPLING**

1 pc 10x40 screw  
2 pcs washers  
1 pc nut

**SMALL**

4 pcs 8x16 screws  
4 pcs washers  
4 pcs nuts



1. Position lower metal sheet (with arrow) under the footrest
2. Position the upper metalsheet over the footrest and start insert the screws, washers and nuts and tighten
3. Couple the trailer hitch onto the holes with the big screw (10x 40) and tighten

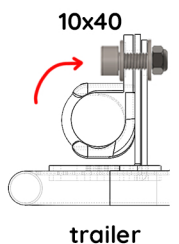
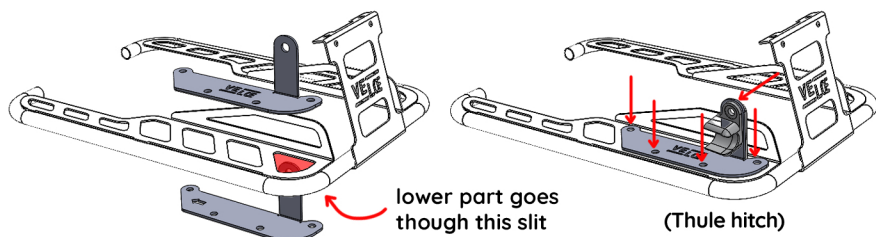

In case of doubt contact your Veloe® retailer for a safe and comfortable ride

© veloe

more accessories at veloe.eu